

90.680.00..TL00

## SANIT Element for support fixing INEO left

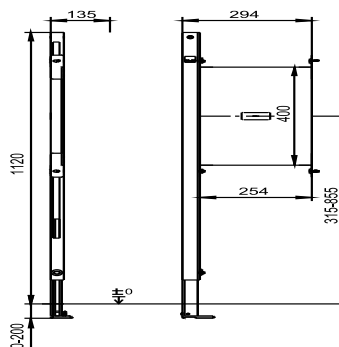

Item number	Product description
90.680.00..TL00	<p>Element for fixing handles and supports, left version  h/w/d: 1,120/294/48 mm, self-supporting, powder-coated steel frame, for covering with plasterboard, installation onto a solid wall, 2-point fastening, self-locking foot with swivel base plate and fastening set, can not be cut, also suitable for bridging gaps of 500 to 1100 mm between elements, adjustment range of foot from unfinished floor level to upper edge of finished floor level: 0-200 mm, adjustment range front to wall: 135-205 mm (when mounted on wall brackets code no. 17.257.00.. T000), packed in a box</p> <p>Accessories:  -wall brackets (pair) code no. 17.257.00..T000  -sound-absorbing sets -extension sets</p>