

05.251.00..0000

## SANIT Multi-corner connection drywall system 996

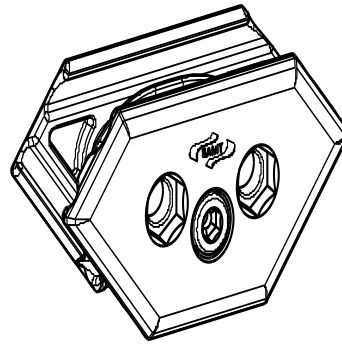

### Item number

05.251.00..0000

### Product description

Multi-corner connector

as transport corner connector for prefabricated walls, 3 connection options for profile bars at 90deg and 45deg angles and parallel to each other, pre-assembled zinc die-cast assembly, with hexagon socket screw M6 (SW5) and spring element, packed in a plastic bag